



**RFP /GHSA/2019/CM002**

**GHSA Request for Proposal (RFP)  
For Selection of Contractors/Vendors**

**Table of Contents**

**Table of Contents** ..... 1

**Introduction:** ..... 2

**RFP Objective:** ..... 3

**5 Application comments** ..... 3

**6. Instructions for submitting proposals** ..... 4

**7. Evaluation and Award Process** ..... 4

**8. Contractual Terms and Conditions** ..... 5

**Introduction:**

The African Society for Laboratory Medicine (ASLM) is a Pan-African professional body, working to advocate for the critical role and needs of laboratory medicine and networks throughout Africa. Medical laboratories play a pivotal role in global disease diagnosis, surveillance, outbreak investigation, initiation and monitoring of therapy, as well as research and development. Unfortunately, medical laboratories in Africa are underdeveloped and cannot meet the testing demands of rapidly growing health delivery services in the 21st century. Inadequate resources and diagnostic services compromise the quality of patient care due to misdiagnosis and consequently results in under or over treatment of disease which presents significant economic and public health challenges.

ASLM through a cooperative agreement with the U.S. Centers for Disease Control and Prevention (CDC), under the Global Health Security Agenda program (GHSa) supports the laboratories in Cameroon for the procurement of equipment and supplies.

ASLM works in close collaboration with governments, local and international organizations, implementing partners, and the private sector in these countries by focusing on four strategic goals:

- Strengthening the laboratory workforce by training and certifying laboratory professionals and clinicians through standardized frameworks
- Transforming laboratory testing quality by enrolling laboratories in quality improvement programs to achieve accreditation by international standards
- Developing strong, harmonized regulatory systems for diagnostic products as defined by the Global Harmonization Taskforce
- Building a network of national public health reference laboratories to improve early disease detection and collaborative research.

**RFP Objective:**

The African Society for Laboratory Medicine (ASLM) is soliciting vendors, contractors, consultants, to submit a proposal for the timely and efficient delivery of the items in the product list (attached as **APPENDIX II and III** to this RFP) to Maroua, Cameroon. Applicants with the capacity to install and offer equipment maintenance contracts for the items above \$5,000 will be preferred. Successful bidders will sign an agreement with ASLM to complete this procurement activity.

The African Society for Laboratory Medicine (ASLM) is soliciting vendors to provide design and setting the **Maroua Regional Laboratory** (Far North, Cameroon) for new equipment installation. Successful bidders will sign an agreement with ASLM to complete the work.

**Scope of Work: For this Requests for Proposal (RFP)** project, the requirements for the sub-contractor are to cover a wide range of multifunctional activities to provide all procurement and resources necessary including but not limited to:

**a) Interior Design:**

- Technical lab bench
- Socket and electrical supplies
- Air conditioner
- Reception area
- Various purpose office rooms' space organization (programs/rooms)
- Ceiling light (1800 Luminex)
- Rest room

**b) Setting :**

- Lab bench
- Sample collection room
- Complete two intensive showers with support for wearing baby diapers
- Floor and showers tiles

**c) Deliver, install, and test new installations;**

Floor plan description and material characteristics and design are following in the **(APPENDIX II AND III)**

**5 Application comments**

Final selection of the contractor(s) will be based on technical, cost and other considerations as deemed necessary by the scope of work. ASLM shall enter into a contract with the selected contractor(s).

- **Period of performance: 03 January 2020 to 21 March 2020**

The review shall include checking deliverables in relation to the scope of work and feedback from target country on performance of the contractor(s). Where the contractor(s) fails to meet the contract requirements, ASLM shall communicate formally of its decision.

**Qualifications for position:**

- 1) Practical documented experience in the design business
- 2) Valid organizational registration documents
- 3) Offers presenting the technical details and precise specifications of the items will be given priority.

**Local vendor are preferred.**

**6. Instructions for submitting proposals**

- A. The format of the submission, in response to this RFP, must include, but not limited, to the following:
- B. Completed proposals shall consist of typewritten pages utilizing 12" font typing. A maximum of 10 pages for the proposal is allowed.
- C. The authorized individual representing the **Respondent** will sign and date the proposal cover sheet. The signatory agent's printed name, title, name of the organization, address, phone and fax numbers and email address must be provided. Failure to provide a signed copy of the affirmation statement below will be cause for the proposal not to be considered.  
*I affirm that the information within this proposal, to the best of my knowledge, is true and accurate. Further, I am duly authorized to sign and submit this proposal on behalf of this agency. I fully affirm and understand that failure to meet the requirements of this proposal at the submitted price may result in my organization's contract being terminated.*
- D. Include at least two (2) current references and their contact information from organizations that have used Respondent's services within the last twelve (12) months.
- E. Send your completed application by email to

[atraore@aslm.org](mailto:atraore@aslm.org) and Copy at [enzeko@aslm.org](mailto:enzeko@aslm.org); [rfpsubmission@aslm.org](mailto:rfpsubmission@aslm.org) by **03 January 2020 (11:59 pm EAT)**.

**Point of contact**

Direct any written questions or request for information about this RFP to:

Aliou Moctar Traore

GHSA Program Coordinator

Email: [atraore@aslm.org](mailto:atraore@aslm.org), [ENZeko@aslm.org](mailto:ENZeko@aslm.org), [rfpsubmission@aslm.org](mailto:rfpsubmission@aslm.org)

Phone Number: +223 72 99 99 14

**7. Evaluation and Award Process**

A team of ASLM staff and outside experts will evaluate the applications based on preset standards relevant to the specific RFP objectives. An evaluation matrix with assigned weighted numerical values will be used to rate each applicant. The following represents some, not all, of the criteria that will be used to the assessed feasibility of each Respondent.

- Does the organization / individual have the right skill set and expertise to accomplish the required assignments?
- Did the Respondent demonstrate knowledge of ASLM's project needs and objectives?

ASLM reserves the right (but is not under obligation to do so) to enter into discussions with one or more Respondents in order to obtain clarifications or additional details, to suggest service delivery refinements in the proposal or other aspects of the proposal, or to negotiate the cost proposal. Formal notification to award the contract and the actual execution of the contract are subject to receipt of funds from the US Centers for Disease Control and Prevention.

Each Respondent submitting a proposal will be notified in writing or via e-mail of ASLM's decision concerning their proposal. Should your organization be recommended for acceptance, the contract shall be effective on the contract execution date and shall run until **Marsh 20th, 2020**. All work must be scheduled and completed within the contract period timeframe. Any modifications or extensions must be negotiated in advance, and submitted to ASLM for review and approval. The selected Respondent's proposal, and any subsequent material submitted in response to requests for additional information, will become the basis of contractual agreements with said Respondent.

#### **8. Contractual Terms and Conditions**

Responses must be in accordance with the guidelines as specified in this RFP. This RFP does not commit ASLM to accept any proposals submitted, nor is ASLM responsible for any costs incurred in the preparation of responses to this RFP. All materials submitted in response to this RFP or developed during the life of the contract will become the property ASLM. The detailed itemized budget must be submitted in US dollars and will be evaluated in terms of best value to ASLM.

ASLM reserves the right to delay, amend, reissue or cancel all or part of this RFP at any time without prior notice. ASLM discourages ex parte communication with any Board member, the public and/or staff member after the deadline for the receipt of proposals. ASLM will be under no obligation to reveal, or discuss with any Respondent on how a proposal was assessed, or to provide any other information relative to the selection process. Respondents whose proposals are not selected will be notified in writing and shall have no claim whatsoever for any kind of compensation.

## Appendix I

### General conditions

#### **WARRANTY**

- The supplier warrants that the items provided by the supplier or sub-contractors will be free from defects.
- If not mentioned elsewhere in the PO or the SA, the warranty for any delivered equipment will not be less than one year from the date of accepting the delivered items. Supplier has to submit a warranty certificate with the invoice and a copy of it to the HAAD's procurement section.

#### **PAYMENT**

- The Purchase Order number must be quoted on all the documents and copy of the Purchase Order and Original Delivery Note should be attached with the invoice.
- The authority will make payment no later than 30 days from the date of receiving invoice.
- All original invoices must be submitted to the Manager of the Finance Department at ASLM.

APPENDIX 2: MAROUA REGIONAL HOSPITAL MICROBIOLOGY FLOOR PLAN

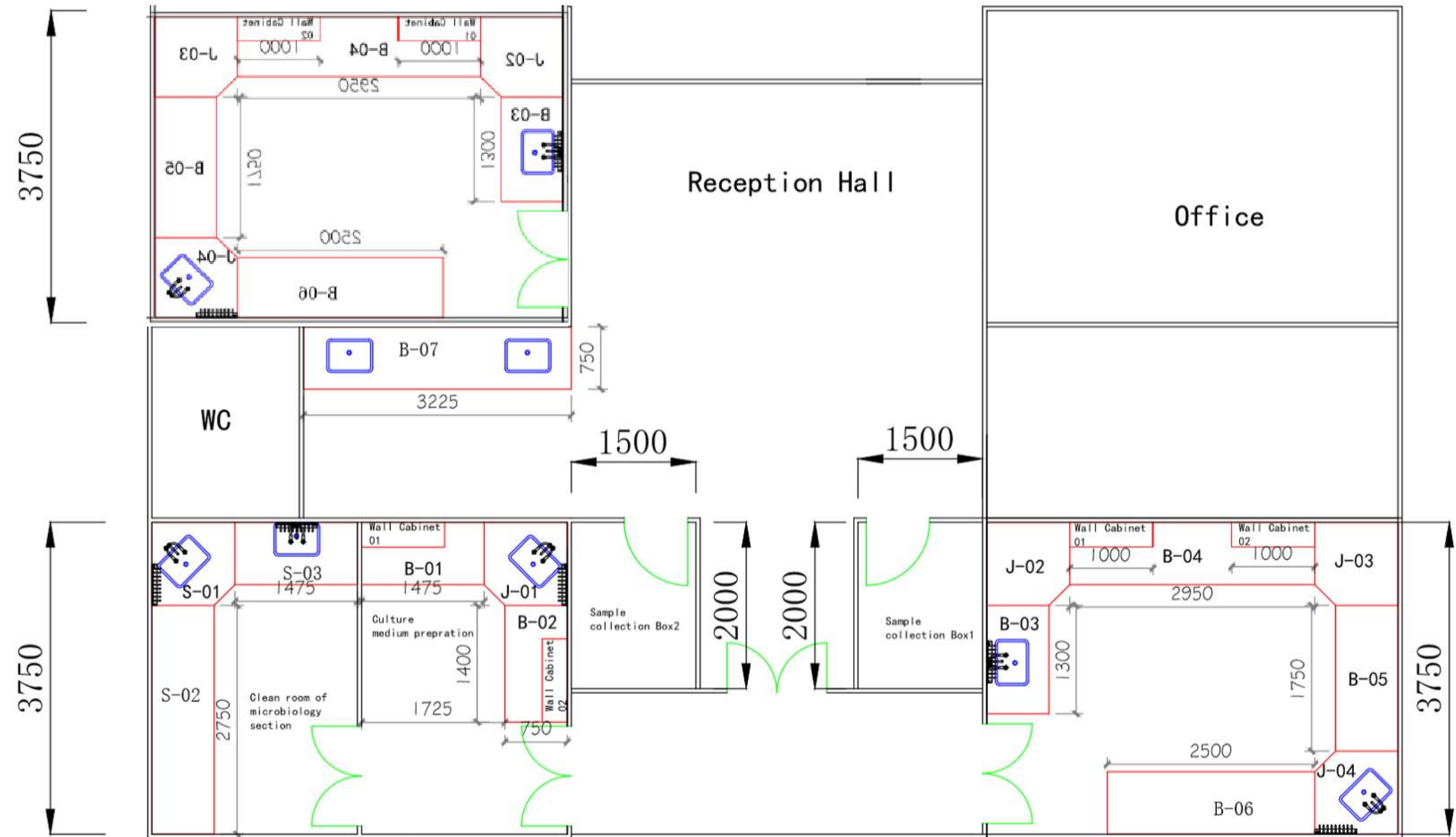



### APPENDIX 3: LIST OF MATERIAL WITH SPECIFICATIONS

Item No.	Description	QTY	Unit
<b>MAROUA REGIONAL HOSPITAL LAB</b>			
1	<b>Stainless Steel Counter Top Wall Bench S-01</b> Dimension (mm):1000(W)*1000(D)*850H Structure: all steel structure Material of the cabinet: 1.2mm thick cold rolled steel coated with electro-static epoxy resin powder  Worktop: 1.0mm thick #304 stainless steel covered with 18mm thick MDF Handle: high quality aluminium handle with  Foot: adjustable (30-50mm) plastic corrosion proof foot		
	Hinge: DTC brand 110degree self-lock hinge	2	pc
	Sink: PP sink size is 555(W)*455(D)*310mm	3	pcs
	Water Tap: three way water tap	3	pc
	PP pegboard: 450*550mm pp pegboard with 32pcs of drip bars	3	pc
	2	<b>Stainless Steel Counter Top Wall Bench S-02</b> Dimension (mm):2750(W)*750(D)*850H Structure: all steel structure  Material of the cabinet: 1.2mm thick cold rolled steel coated with electro-static epoxy resin powder  Worktop: 1.0mm thick #304 stainless steel covered with 18mm thick MDF Handle: high quality aluminium handle with  Foot: adjustable (30-50mm) plastic corrosion proof foot Hinge: DTC brand 110degree self-lock hinge  Rails of the drawers: DTC brand three mute-slide, low noise	
		2	pcs
Wall Cabinet: 1000(W)*300(D)*600(H), steel cabinet, two doors with 5mm thick tempered glass, 1shelf height is adjustable and loading capacity is 50KG		4	pcs
Socket: lab use socket with iron box		6	pcs

Item No.	Description	QTY	Unit
3	<p><b>Stainless Steel Counter Top Wall</b>                      Dimension (mm):1475(W)*750(D)*850H                      Structure: all steel structure                      Material of the cabinet: 1.2mm thick cold rolled steel coated with electro-static epoxy resin powder</p> <p>Worktop: 1.0mm thick #304 stainless steel covered with 18mm thick MDF                      Handle: high quality aluminium handle with                      Foot: adjustable (30-50mm) plastic corrosion proof                      Hinge: DTC brand 110degree self-lock hinge</p> <p>Rails of the drawers: DTC brand three mute-slide, low noise                      Socket: lab use socket with iron box</p>		
		2	pcs
		8	pcs
4	<p><b>Wall Bench B-01</b>                      Dimension (mm):1475W)*750(D)*850H                      Structure: all steel structure                      Material of the cabinet: 1.2mm thick cold rolled steel coated with electro-static epoxy resin powder</p> <p>Worktop: 12.7mm thick phenolic resin board, up to 25.4mm at adges                      Handle: high quality aluminium handle with                      Foot: adjustable (30-50mm) plastic corrosion proof foot                      Hinge: DTC brand 110degree self-lock hinge                      Rails of the drawers: DTC brand three mute-slide, low noise</p> <p>Wall Cabinet: 1000(W)*300(D)*600(H), steel cabinet, two doors with 5mm thick tempered glass, 1shelf height is adjustable and loading capacity is 50KG                      Socket: lab use socket with iron box</p>		
		2	pcs
		2	pcs
5	<p><b>Wall Bench B-02</b>                      Dimension (mm):1400W)*750(D)*850H                      Material of the cabinet: 1.2mm thick cold rolled steel coated with electro-static epoxy resin powder</p>		
		2	pcs

Item No.	Description	QTY	Unit
	Worktop: 12.7mm thick phenolic resin board, up to 25.4mm at edges Handle: high quality aluminium handle with  Foot: adjustable (30-50mm) plastic corrosion proof foot Hinge: DTC brand 110degree self-lock hinge  Rails of the drawers: DTC brand three mute-slide, low noise		
	Wall Cabinet: 1000(W)*300(D)*600(H), steel cabinet, two doors with 5mm thick tempered glass, 1shelf height is adjustable and loading capacity is 50KG	2	pcs
	Socket: lab use socket with iron box	2	pcs
6	<p><b>Corner Bench J-01</b>                      Dimension (mm):1000(W)*1000(D)*850H                      Structure: all steel structure                      Material of the cabinet: 1.2mm thick cold rolled steel coated with electro-static epoxy resin powder</p> <p>Worktop: 12.7mm thick phenolic resin board, up to 25.4mm at edges                      Handle: high quality aluminium handle with                       Foot: adjustable (30-50mm) plastic corrosion proof foot                      Hinge: DTC brand 110degree self-lock hinge                      Sink: PP sink size is 555(W)*455(D)*310mm                      Water Tap: three way water tap</p> <p>PP pegboard: 450*550mm pp pegboard with 32pcs of drip bars</p>	3	pcs
		3	pcs
7	<p><b>Wall Bench B-03</b>                      Dimension (mm):2300(W)*750(D)*850H                      Structure: all steel structure                      Material of the cabinet: 1.2mm thick cold rolled steel coated with electro-static epoxy resin powder</p> <p>Worktop: 12.7mm thick phenolic resin board, up to 25.4mm at edges                      Handle: high quality aluminium handle with</p>	2	pcs

Item No.	Description	QTY	Unit
	Foot: adjustable (30-50mm) plastic corrosion proof foot Hinge: DTC brand 110degree self-lock hinge  Rails of the drawers: DTC brand three mute-slide, low noise Sink: PP sink size is 555(W)*455(D)*310mm Water Tap: three way water tap  PP pegboard: 450*550mm pp pegboard with 32pcs of drip bars Socket: lab use socket with iron box		
8	<b>Corner Bench J-01 and J-02</b> Dimension (mm):1000(W)*1000(D)*850H Structure: all steel structure Material of the cabinet: 1.2mm thick cold rolled steel coated with electro-static epoxy resin powder  Worktop: 12.7mm thick phenolic resin board, up to 25.4mm at adges  Handle: high quality aluminium handle with Foot: adjustable (30-50mm) plastic corrosion proof foot Hinge: DTC brand 110degree self-lock hinge  Rails of the drawers: DTC brand three mute-slide, low noise	2	pcs
		2	pcs
		2	pcs
9	<b>Wall Bench B-04</b> Dimension (mm):2950W)*750(D)*850H Structure: all steel structure Material of the cabinet: 1.2mm thick cold rolled steel coated with electro-static epoxy resin powder  Worktop: 12.7mm thick phenolic resin board, up to 25.4mm at adges Handle: high quality aluminium handle with  Foot: adjustable (30-50mm) plastic corrosion proof foot Hinge: DTC brand 110degree self-lock hinge  Rails of the drawers: DTC brand three mute-slide, low noise	2	pcs

Item No.	Description	QTY	Unit
	Wall Cabinet: 1000(W)*300(D)*600(H), steel cabinet, two doors with 5mm thick tempered glass, 1shelf height is adjustable and loading capacity is 50KG	4	pcs
	Socket: lab use socket with iron box	6	pcs
10	<p><b>Wall Bench B-05</b>            Dimension (mm):2750W)*750(D)*850H            Structure: all steel structure            Material of the cabinet: 1.2mm thick cold rolled steel coated with electro-static epoxy resin powder</p> <p>Worktop: 12.7mm thick phenolic resin board, 25.4mm at adgesup to            Handle: high quality aluminium handle with</p> <p>Foot: adjustable (30-50mm) plastic corrosion proof foot            Hinge: DTC brand 110degree self-lock hinge</p> <p>Rails of the drawers: DTC brand three mute-slide, low noise            Socket: lab use socket with iron box</p>	2	pcs
		6	pcs
11	<p><b>Wall Bench B-06</b>            Dimension (mm):2500W)*750(D)*850H            Structure: all steel structure</p> <p>Material of the cabinet: 1.2mm thick cold rolled steel coated with electro-static epoxy resin powder</p> <p>Worktop: 12.7mm thick phenolic resin board, up to 25.4mm at adges            Handle: high quality aluminium handle with</p> <p>Foot: adjustable (30-50mm) plastic corrosion proof foot            Hinge: DTC brand 110degree self-lock hinge</p> <p>Rails of the drawers: DTC brand three mute-slide, low noise            Socket: lab use socket with iron box</p>	2	pcs
12	<p><b>Corner Bench J-04</b>            Dimension (mm):1000(W)*1000(D)*850H            Structure: all steel structure</p>	2	pcs

Item No.	Description	QTY	Unit
	Material of the cabinet: 1.2mm thick cold rolled steel coated with electro-static epoxy resin powder		
	Worktop: 12.7mm thick phenolic resin board, up to 25.4mm at adges		
	Handle: high quality aluminium handle with		
	Foot: adjustable (30-50mm) plastic corrosion proof foot		
	Hinge: DTC brand 110degree self-lock hinge		
	Sink: PP sink size is 555(W)*455(D)*310mm	3	pcs
	Water Tap: three way water tap	3	pcs
	PP pegboard: 450*550mm pp pegboard with 32pcs of drip bars	3	pcs
13	<b>Wall Bench B-07</b> Dimension (mm):3225(W)*750(D)*850H Structure: all steel structure Material of the cabinet: 1.2mm thick cold rolled steel coated with electro-static epoxy resin powder		
	Worktop: 12.7mm thick phenolic resin board, up to 25.4mm at adges		
	Handle: high quality aluminium handle with		
	Foot: adjustable (30-50mm) plastic corrosion proof foot		
	Hinge: DTC brand 110degree self-lock hinge		
	Rails of the drawers: DTC brand three mute-slide, low noise	2	pcs
	Sink: PP sink size is 555(W)*455(D)*310mm	4	pcs
	Socket: lab use socket with iron box	4	pcs
14	<b>Cubic case</b> dimension (mm): 200(w) * 150(D)*220(H) structure: Material of cabinet: Worktop: Handle: high quality glasse		
		3	pcs
	<b>Lab Setting</b>	ens	1

Item No.	Description	QTY	Unit
15	Supply and installation of the DAIKIN VRV series Variable RPM version R410A air conditioning unit or similar type RXYSQ4P including any suggestions for installation and normal operation	u	5
	<b>Others</b>		
16	2-pole circuit breaker, C10A, type C60N	u	4
	4 pole circuit breaker, D25A, type C60N	u	3
	Metal cabinet on base L = (650 + 150) mm, P = 400mm, H = 2000mm type PRISMA P from SCHNEIDER or equivalent including busbar, wiring accessories, connection and fixing	u	2
	<b>Lighting</b>		
17	02-Waterproof luminaire 2x36W brand THORN, type AQUAF2 2x36W T26 HF L840 or equivalent	u	8
	OMEGA2 3x14 T16 HF DSB L840 96504778 Dimensions: 597 x 597 x 59 mm Total power: 47 W Weight: 4.1 kg	u	30
	AQUAF2 2x36W T26 HF L840 96503092 Dimensions: 1300 x 143 x 111 mm Total power: 72 W Weight: 2.6 kg	u	1
	<b>Electricity</b>		
18	H07V-R 2,5mm <sup>2</sup>	m	45
	Cable U1000R02V 3x1, 5mm <sup>2</sup>	m	50
	Cable U1000R02V 3x2, 5mm <sup>2</sup>	m	30
	apparent box 6 modules not equipped	u	6
	junction box and square boxes with screws	u	2
<b>Technical parameter of lab bench and cabinet</b>			
<ul style="list-style-type: none"> <li>Material of the cabinet: 1.2mm thick cold rolled steel coated with electro-static epoxy resin powder</li> <li>Worktop: 12.7mm thick phenolic resin board, up to 25.4mm at adges</li> <li>Handle: high quality aluminium handle with</li> <li>Foot: adjustable (30-50mm) plastic corrosion proof foot</li> <li>Hinge: DTC brand 110degree self-lock hinge</li> <li>Rails of the drawers: DTC brand three mute-slide, low noise</li> <li>Wall Cabinet: 1000(W)*300(D)*600(H), steel cabinet, two doors with 5mm thick tempered glass, 1shelf height is adjustable and loading capacity is more than 50KG</li> <li>Socket: lab use socket with iron box</li> <li>PP pegboard: 450*550mm pp pegboard with 32pcs of drip bars</li> </ul>			